



Global Consulting Inc.

"Managing projects to success"

1-PC WAFER FLANGE BALL VALVE



Global Consulting Inc.
"Managing Projects to Success"



KSPM-34 (1/2"~3/4")

1-pc Wafer Flange Ball Valve

- Investment casting for body and cap
- Flange ends DIN2543
- Pressure rating PN16
- Working temperature -25°C + 180°C
- Material CF8M, CF8, CF3M, WCB

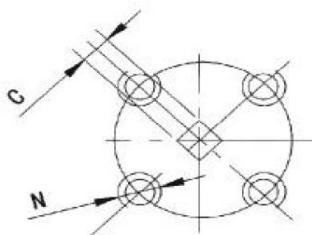
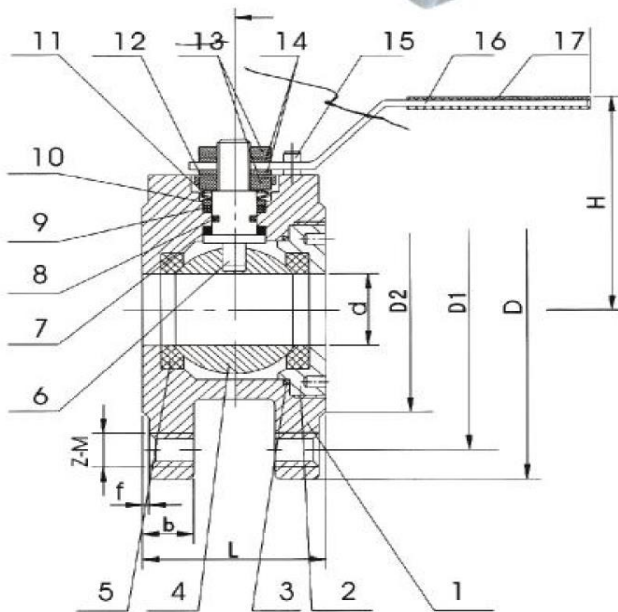

ISO 5211

DIMENSION LIST

SIZE	d	L	D	D1	D2	b	f	H	W	C	N	ISO5211	Z-M	N • m	Kgs
1/2"	15	36	95	65	45	12	2	70	115	9	M5	F03	4-M12	5	1.11
3/4"	20	38	105	75	58	12	2	78	115	9	M5	F03	4-M12	8	1.48

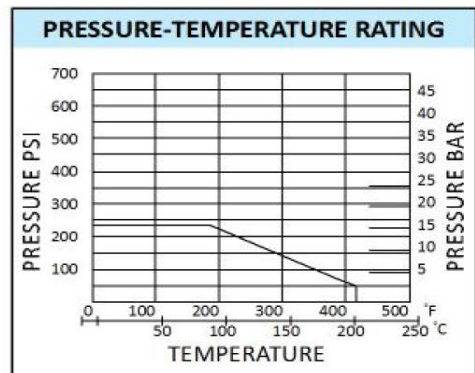

MATERIAL LIST

ITEM	PART	MATERIAL	QTY
1	Body	CF8M	1
2	Cap	CF8M	1
3	Body Gasket	PTEF	1
4	Ball	SS316	1
5	Ball Seat	R-PTFE (15%)	2
6	Stem	SS316	1
7	Thrust Washer	PTFE	1
8	O-Ring	VITON	1
9	Stem Packing	PTFE	1
10	Packing Ring	SS304	1
11	Belleville Washer	SS301	2
12	Nut Stopper	SS304	1
13	Nut	SS304	2
14	Plate Washer	SS304	2
15	Lock Device	SS304	1
16	Handle	SS304	1
17	Plastic Cover	PLASTIC	1



Global Consulting Inc.
 "Managing Projects to Success"



KSPM-34 (1" ~ 4")

1-pc Wafer Flange Ball Valve

- Investment casting for body and cap
- Flange ends DIN2543
- Pressure rating PN16
- Working temperature -25°C + 180°C
- Material CF8M, CF8, CF3M, WCB

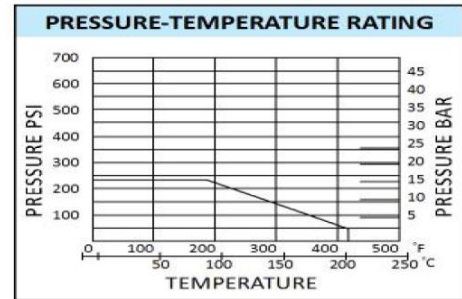
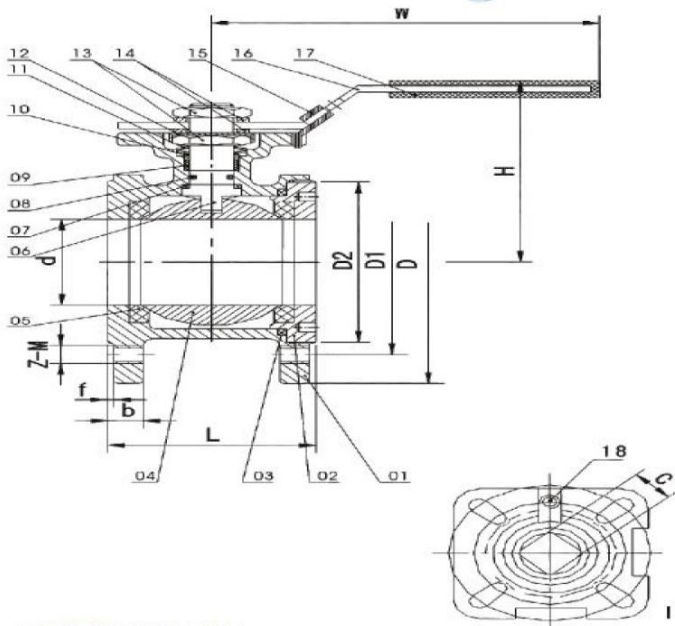

DIMENSION LIST

SIZE	d	L	D	D1	D2	b	f	H	W	C	ISO5211	Z-M	N • m	Kgs
1"	20	50	115	85	68	12	2	90	160	11	F04/F05	4-M12	10	1.95
1-1/4"	32	53	140	100	78	14	2	100	160	11	F04/F05	4-M16	14	3.10
1-1/2"	40	65	150	110	88	15	3	105	200	14	F05/F07	4-M16	18	4.18
2"	50	78	165	125	102	16	3	125	200	14	F05/F07	4-M16	25	5.37
2-1/2"	65	98	185	145	122	16	3	140	255	17	F07/F10	4-M16	48	8.18
3"	76	118	200	160	138	18	3	145	255	17	F07/F10	8-M16	75	11.92
4"	94	140	220	180	158	18	3	175	300	17	F07/F10	8-M16	110	16.92

MATERIAL LIST

ITEM	PART	MATERIAL	QTY
1	Body	CF8M	1
2	Cap	CF8M	1
3	Body Gasket	PTFE	1
4	Ball	SS316	1
5	Ball Seat	R-PTFE (15%)	2
6	Stem	SS316	1
7	Thrust Washer	PTFE	1
8	O-Ring	VITON	1
9	Stem Packing	PTFE	1
10	Packing Ring	SS304	1
11	Belleville Washer	SS301	2
12	Nut Stopper	SS304	1
13	Nut	SS304	2
14	Plate Washer	SS304	2
15	Lock Device	SS304	1
16	Handle	SS304	1
17	Plastic Cover	PLASTIC	1
18	Stop Pin	SS304	

www.kspmglobal.ca



Kspm Global Consulting Inc.

Head Office:

1113 Kestell Blvd., Oakville, Ontario L6H 7M6 Canada.

Website: www.kspmglobal.ca

E-mail: Operations@kspmglobal.ca